

# LSS



## Socket for Music Stand Lights

The LSS Socket for Music Stand Lights has been specially developed for the power supply of music stand lights. The socket is designed for safety extra-low voltages up to 50 V AC/DC / max. 16 A. For installation under the orchestra pit floor, the socket is equipped with a duct for floor thicknesses of 45 mm and 50 mm. The length of duct can be adapted to other floor thicknesses. In order to see the socket on the orchestra floor even in the dark, an optional LED orientation light with a small amount of light can be installed.

The LSS Socket for Music Stand Lights uses jack plugs with a diameter of 10.0 mm. The connectors are locked in the socket by spring locks. The socket is power supplied via internal lever terminals for conductor diameters from 0.2 to 10.0 mm<sup>2</sup> (see Technical Specifications). Two terminals are available for each connection pole for looping through the connection lines.

The housing of the LSS Socket for Music Stand Lights consists of 1.5 mm sheet steel, powder-coated pearl night blue (RAL 5026). Six entries for cable glands (M25) are pre-punched on three sides of the housing for the electrical installation. Four holes for screw mounting are provided on the mounting level of the housing. For dirt particles that can get into the housing when cleaning, the bottom plate is equipped with a central opening directly below the duct.

## Technical Specifications:

<b>Output</b>	10.0 mm jack plugs with 2-pins, <50 V AC/DC / 16 A, spring locks	
<b>Input cross-sections</b>	Single wire conductor	0.2 – 10 mm <sup>2</sup> / 24 – 8 AWG
	Fine-stranded conductor	0.2 – 10 mm <sup>2</sup> / 24 – 8 AWG
	Fine stranded conductor with ferrule and plastic collar	0.25 – 6 mm <sup>2</sup>
	Fine stranded conductor with ferrule, without plastic collar	0.25 – 6 mm <sup>2</sup>
	Stripping length	11 – 13 mm
<b>Housing</b>	1.5 mm sheet steel, powder-coated pearl night blue (RAL 5026)	
<b>Knockout openings</b>	6x M25 on three sides	
<b>RoHS</b>	Approval	
<b>IP Code/Appliance classes</b>	IP 10 / Class III	
<b>Weight</b>	About 650 g	
<b>Dimensions Housing</b>	(L x W x H in mm): 110 x 110 x 41,5	
<b>Length connector for TRS connector</b>	For floor thicknesses of 45 mm: 43 mm For floor thicknesses of 50 mm: 48 mm Other lengths possible on request.	
<b>Optional equipment</b>	Internal lighting to locate the socket Luminous flux: 28 lm Luminous color: cold white	
<b>Order number</b>	L06004	

## Drawings

### Perspective view

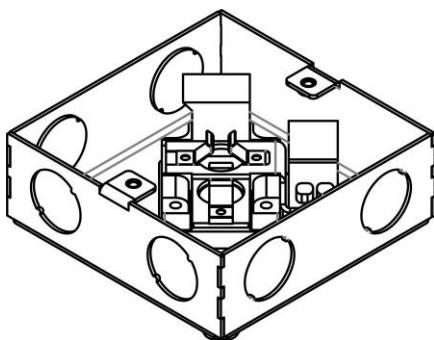

Housing open, Bottom view

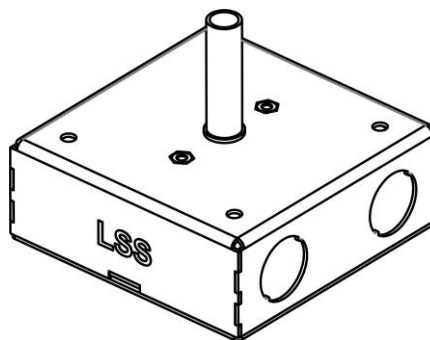

View from above

### Dimensions

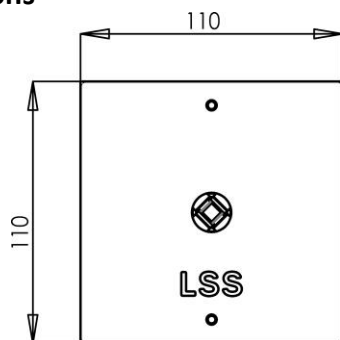

Bottom view

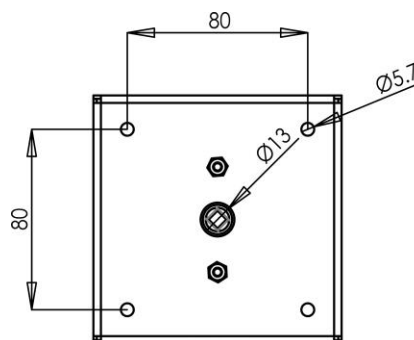

View from above

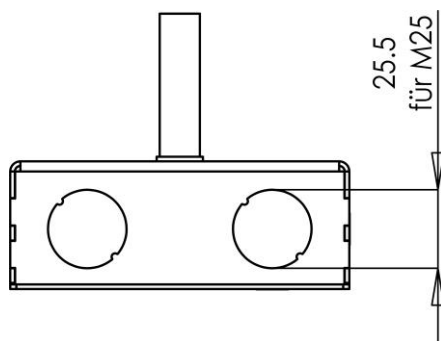

Sideview

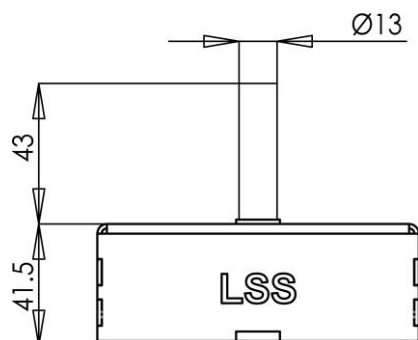

For floor thicknesses of 45 mm

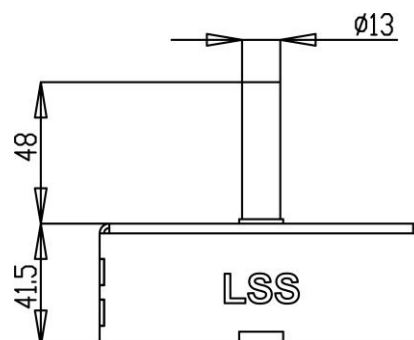

For floor thicknesses of 50 mm