

# LSS



## **KBL – Small LED blue light Compact blue light for theaters**

The KBL is the compact white and/or blue light by LSS and was developed for use in theaters. It can be used as a wall or ceiling light and as a surface-mounted or flush-mounted model. The KBL from LSS can be installed in offset boxes, ducts, and even in wall cladding. Their versatility and small dimensions make them a universally usable luminaire in corridors, galleries, on stage for stage managers desks, and many other places.

Either a 230 V AC or a 24 V DC fixed installation can be used as the power supply for the LSS KBL. The KBL can also be dimmed when operating with 24 V DC. Also, PWM or analog dimmers can be used. The LSS 4-Channel KBL Dimmer (order number 5258), which is matched to the KBL lights, also enables the KBL to be controlled via DMX.

The LSS KBL is equipped with energy-saving, low-maintenance, and long-life LEDs. The lighting surface is almost rectangular and is illuminated evenly. To prevent unwanted radiation or to reduce the lighting area, sliding covers are optionally available.

The small blue light LSS KBL is supplied in a powder-coated sheet steel housing.

## Technical Specifications

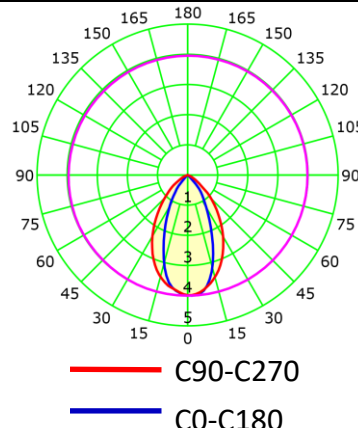
<b>Blue LED</b>	Number of LED: 4	
	Wavelength: around 470 nm	
	Luminous flux: 4,6 lm	
	Beam angle: ca. 35° x 80°	
	Stock, other LED / colors available on request.	
<b>White LED</b>	Number of LED: 4	
	Luminous flux: 5 lm	
	Color temperature: 5000 K	
	Stock, other LED / colors available on request.	
<b>Cable entry</b>	6 possible M20 screw connections	
<b>Surface house</b>	(two breakouts each on three sides)	
<b>Power Supply</b>	KBL 24N:	24 V DC / 0.02 A
	KBL 230N:	100-250 V AC / 0.02 A
<b>Power consumption</b>	KBL 24N:	0.5 W
	KBL 230N:	5 VA
<b>IP Code/ Appliance classes</b>	KBL 24N:	IP30 / Class 3
	KBL 230N:	IP30 / Class 1
<b>Operating temperature</b>	0 °C – 50 °C, not condensing	
<b>Housing</b>	1.5 mm sheet steel housing / RAL9005 black powder-coated	
<b>RoHS</b>	conform	
<b>Weight</b>	Approx. 330 g without connection cable including surface-mounted housing	
<b>Dimensions (W x H x D in mm)</b>	without surface housing:	80 x 80 x 30
	with surface housing:	80 x 80 x 57,50
<b>Optional accessories</b>	<ul style="list-style-type: none"> <li>• U-shaped cover</li> <li>• Cover for ceiling mounting</li> </ul>	
<b>Order number</b>	Blue light LED	
	KBL 24N:	L01002
	KBL 230N:	L01006
	White light	
	KWL 24N:	L01020
	Accessory	
	Housing for	
	Surface mounting:	L01003

## Dimensions

**Top view wall unit**

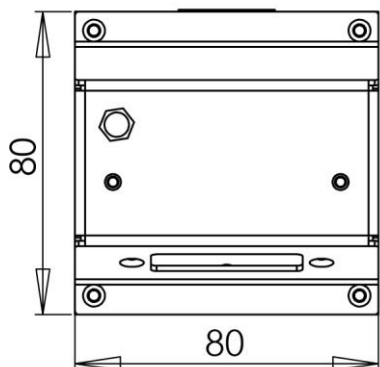

**Side view with a surface-mounted housing**

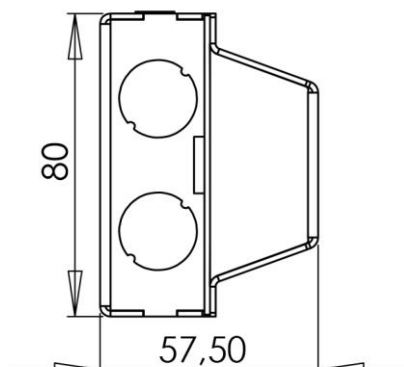

**Side view without a surface-mounted housing**

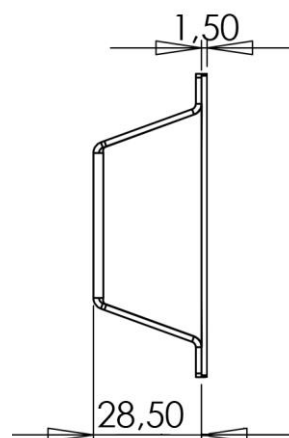

**Top for wall mounting**

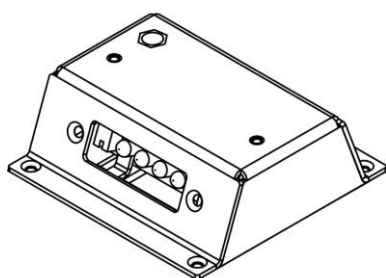

**Top for ceiling mounting**

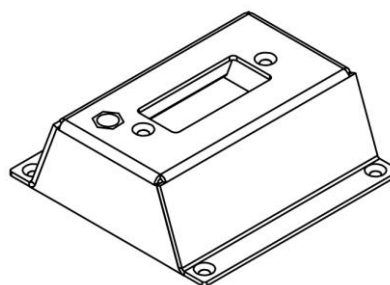

**Cover for wall mounting**

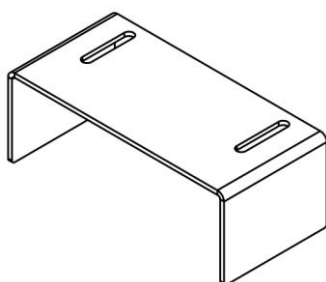

**Cover for ceiling mounting**

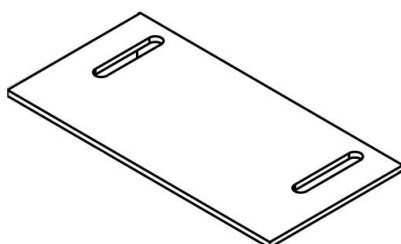

**Drill template base**

