

LSS



DMX Schalt-Schuko 2

DMX switchable Schuko plug with RDM

The LSS DMX Schalt-Schuko 2 is a built-in Schuko plug that can be switched on and off via DMX. A bistable relay is used for this, which only requires power for switching. A holding current is not necessary. The relay has a switching capacity of a maximum of 11.5 kVA (230 V / 50 A). It is oversized so that it can also switch capacitive or halogen loads with high inrush currents without any problems.

The LSS DMX Schalt-Schuko 2 can be parameterized via RDM. It has electronically switchable DMX termination, temperature measurement and monitoring. All measured values and settings are reported to the user via the network. Operating status and error messages are also displayed via LEDs on the device. These LEDs can be switched off for use in the stage area.

The power supply of the LSS DMX Schalt-Schuko 2 is generated by the 230 V mains voltage so that only one supply line is required. The input terminals are designed twice to supply several built-in sockets in series with voltage.

General technical data:

Design	Open Frame
Switchable loads:	Max. 3,5 kW resistive load Inductive and capacitive loads possible.
Plug-in:	PCE IP54 Schuko
Protective conductor:	Separately executed connection
RoHS Approval:	Compliant
Dimensions (W x H x D):	52 x 90 x 78 mm
Minimum installation depth:	65 mm

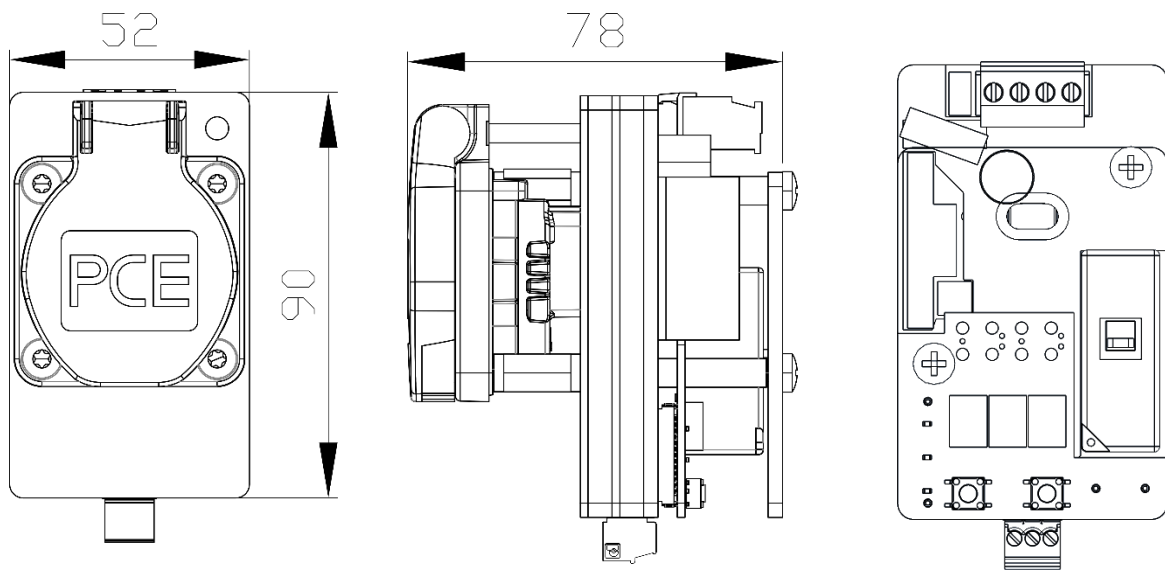

Order number:	5261
----------------------	------

Power supply:

Incoming:	85 ~ 264 V AC / 50 Hz
Ampacity:	max. 16 A
Biasing:	max. 30 mA

Connection terminals and wire cross-sections:

Connection	Terminal	Solid in mm ²	Flexible in mm ²	Electric wire ferrule in mm ²	
				Insulated	Uninsulated
DMX	3 pins	0,14...1,5	0,14...1,5	0,25...1,5	0,25...0,5
Power supply	4 pins	0,205...3,31 (24...12 AWG)	0,205...3,31 (24...12 AWG)	3.5 Lb-In / 0.40 Nm	3.5 Lb-In / 0.40 Nm